

# Licence Number EAWML 100321

## Facility Type: Household, Commercial and Industrial Waste Transfer Station with Treatment

Environmental Protection Act 1990

---

JBT Waste Services Limited  
Stephenson Way  
Barrington Industrial Estate  
Bedlington  
Northumberland  
NE22 7DG

### Contents

LICENCE .....	2
CONDITIONS.....	3
1 – MANAGEMENT .....	3
2 – OPERATIONS .....	3
3 – EMISSIONS AND MONITORING .....	4
4 – INFORMATION .....	5
SCHEDULE 1- SITE PLAN .....	8
SCHEDULE 1- SITE PLAN .....	8
SCHEDULE 2 - OPERATIONS.....	9
SCHEDULE 3 – INTERPRETATION .....	22

# Licence

Environmental Protection Act 1990  
Waste Management Licensing  
Regulations 1994



## Waste Management Licence Number EAWML100321 Facility Type: Household Commercial and Industrial Waste Transfer Station with Treatment

The Environment Agency ("the Agency") in exercise of its powers under section 36 of the Environmental Protection Act 1990, hereby authorises:

**JBT Waste Services Limited** ("the licence holder"),

whose registered office (or principal place of business) is

**Barrington Industrial Estate, Bedlington, Northumberland, NE22 7DG**

**Company registration number 04696376**

to carry out the keeping and treatment of waste at

**Stephenson Way, Barrington Industrial Estate, Bedlington, Northumberland,  
NE22 7DL**

the boundary of which is shown on the site plan at schedule 1 to this licence

to the extent authorised by and subject to the conditions of this licence.

Signed	Date
	29 <sup>th</sup> September 2008

*Jane McNamara*

Authorised to sign on behalf of the Agency

---

# Conditions

## 1 – MANAGEMENT

### 1.1 General management

1.1.1 The activities shall be managed and operated:

- (a) in accordance with a management system, which identifies and minimises risks of pollution, including those arising from operations, maintenance, accidents, incidents and non-conformances and those drawn to the attention of the licence holder as a result of complaints; and
- (b) by sufficient persons who are competent in respect of the responsibilities to be undertaken by them in connection with the operation of the activities.

1.1.2 Records demonstrating compliance with condition 1.1.1 shall be maintained.

1.1.3 Any persons having duties that are or may be affected by the matters set out in this licence shall have convenient access to a copy of it kept at or near the place where those duties are carried out.

### 1.2 Accident management plan

1.2.1 The licence holder shall:

- (a) maintain and implement an accident management plan;
- (b) review and record at least every 4 years or as soon as practicable after an accident, (whichever is the earlier) whether changes to the plan should be made;
- (c) make any appropriate changes to the plan identified by a review.

### 1.3 Site security

1.3.1 Site security measures shall prevent unauthorised access to the site, as far as practicable.

## 2 – OPERATIONS

### 2.1 Licensed activities

2.1.1 The licence holder is authorised to carry out the activities specified in schedule 2, table 2.1 ("the activities").

2.1.2 The storage (including temporary storage) and treatment of WEEE shall be carried out in accordance with the technical requirements of Annex III of the WEEE Directive.

2.1.3 WEEE shall be treated using best available treatment, recovery and recycling techniques (BATRRT).

2.1.4 As a minimum, the substances, preparations and components specified in schedule 4 shall be removed from any separately collected WEEE.

- 
- 2.1.5 All fluids contained within any WEEE to be treated at the site shall be removed prior to treatment taking place.
- 2.1.6 Separately collected components of WEEE listed in schedule 2, table 2.2 shall be treated in accordance with the methods specified in that table.
- 2.1.7 Equipment shall be provided to record the weight of untreated WEEE accepted at, and components and materials leaving, the facility.

## **2.2 Waste acceptance**

- 2.2.1 Waste shall only be accepted if:
- (a) it is of a type and quantity listed in schedule 2, table 2.2; and
  - (b) it conforms to the description in the documentation supplied by the producer and holder.
- 2.2.2 Records shall be maintained of all waste accepted onto the site.

# **3 – EMISSIONS AND MONITORING**

## **3.1 Emissions to air, water or land**

- 3.1.1 There shall be no point source emissions to air, water or land.

## **3.2 Transfers off-site**

- 3.2.1 Records of all the wastes sent off site from the activities, for either disposal or recovery shall be maintained.

## **3.3 Fugitive emissions of substances**

- 3.3.1 Fugitive emissions of substances (excluding odour and noise) shall not cause pollution. The licence holder shall not be taken to have breached this condition if appropriate measures have been taken to prevent or where that is not practicable, to minimise, those emissions.
- 3.3.2 Litter or mud arising from the activities shall not cause pollution. The licence holder shall not be taken to have breached this condition if appropriate measures have been taken to prevent or where that is not practicable, to minimise, the litter and mud.
- 3.3.3 Litter and mud arising from the activities shall be cleared from affected areas outside the site as soon as practicable.
- 3.3.4 All liquid wastes, whose emission to water or land could cause pollution, shall be provided with secondary containment, unless the licence holder has used other appropriate measures to prevent or where that is not practicable, to minimise, leakage and spillage from the primary container.

---

### **3.4 Odour**

3.4.1 Emissions from the activities shall be free from odour at levels likely to cause annoyance outside the site, as perceived by an authorised officer of the Agency, unless the licence holder has used appropriate measures to prevent or where that is not practicable, to minimise, the odour.

### **3.5 Noise**

3.5.1 Emissions from the activities shall be free from noise at levels likely to cause annoyance outside the site, as perceived by an authorised officer of the Agency, unless the licence holder has used appropriate measures to prevent or where that is not practicable, to minimise, the noise.

### **3.6 Pests**

3.6.1 Scavenging animals, scavenging birds and other pests shall not cause pollution. The licence holder shall not be taken to have breached this condition if appropriate measures have been taken to prevent or where that is not practicable, to minimise, such pollution.

### **3.7 Monitoring**

3.7.1 This licence does not require any monitoring of the activities, emissions or the environment.

## **4 – INFORMATION**

### **4.1 Records**

4.1.1 All records required to be made by this licence shall:

- (a) be legible;
- (b) be made as soon as reasonably practicable;
- (c) if amended, be amended in such a way that the original and any subsequent amendments remain legible or are capable of retrieval; and
- (d) be retained, unless otherwise agreed by the Agency, for at least 6 years from the date when the records were made, or in the case of the following records until licence surrender:
  - (i) off-site environmental and health effects; and
  - (ii) the condition of land and groundwater.

4.1.2 Any records required to be made by this licence shall be supplied to the Agency within 14 days, where the records have been requested in writing by the Agency.

### **4.2 Reporting**

4.2.1 All reports and notifications required by the licence shall be sent to the Agency using the contact details supplied in writing by the Agency.

4.2.2 A summary report of the waste types and quantities accepted and removed from the site shall be made for each quarter. It shall be submitted to the Agency within one month of the end of the quarter and shall be in the format required by the Agency.

---

## 4.3 Notifications

- 4.3.1 The Agency shall be notified without delay following the detection of:
- (a) any malfunction, breakdown or failure of equipment or techniques, accident or fugitive emission which has caused, is causing or may cause significant pollution;
  - (b) the breach of a limit specified in this licence; and
  - (c) any significant adverse environmental and health effects.
- 4.3.2 Written confirmation of actual or potential pollution incidents and breaches of emission limits shall be submitted within 24 hours.
- 4.3.3 Prior written notification shall be given to the Agency of the following events and in the specified timescales:
- (a) as soon as practicable prior to the permanent cessation of any of the activities;
  - (b) cessation of operation of all or part of the activities for a period likely to exceed 3 months;
  - (c) resumption of the operation of all or part of the activities after a cessation notified under (b) above
- 4.3.4 Where the Agency has requested in writing that it shall be notified when the licence holder is to undertake monitoring and/or spot sampling, the licence holder shall inform the Agency when the relevant monitoring is to take place. The licence holder shall provide this information to the Agency at least 14 days before the date the monitoring is to be undertaken.
- 4.3.5 The Agency shall be notified within 7 days of any changes in technically competent management and the name of any incoming person together with evidence that such person has the required technical competence.
- 4.3.6 The Agency shall be notified within 14 days of the licence holder and/or any relevant person being convicted of a relevant offence, (unless such information has already been notified to the Agency), with details of the nature of the offence, the place and date of conviction, and the sentence imposed.
- 4.3.7 The Agency shall be notified within 14 days of the licence holder and/or any relevant person lodging an appeal against a conviction for any relevant offence and of the outcome when the appeal is decided.
- 4.3.8 The Agency shall be notified within 14 days of the occurrence of the following matters except where such disclosure is prohibited by Stock Exchange rules:
- a) Where the licence holder is a registered company:
    - any change in the licence holder's trading name, registered name or registered office address
    - any change to particulars of the licence holder's ultimate holding company (including details of an ultimate holding company where a licence holder has become a subsidiary);
    - any steps taken with a view to the licence holder going into administration, entering into a company voluntary arrangement or being wound up; and
    - if the licence holder is not the operator: any change in the operators trading name; address; registered name or registered office address.
  - b) Where the licence holder is a corporate body other than a registered company:
    - any change in the licence holder's name or address;
    - any steps taken with a view to the dissolution of the licence holder; and
    - if the licence holder is not the operator: any change in the operators trading name; address; registered name or registered office address.
  - c) In any other case:
    - the death of any of the named licence holders (where the licence holder consists of more

- 
- than one named individual);
- any steps taken with a view to the licence holder, or any one of them, going into bankruptcy, entering into a composition or arrangement with creditors, or, in the case them being in a partnership, dissolving the partnership; and
  - if the licence holder is not the operator: any change in the operators trading name; address; registered name or registered office address.

4.3.9 The Agency shall be notified at least 7 days in advance of the commencement of any of the activities.

## **4.4 Interpretation**

4.4.1 In this licence the expressions listed in schedule 3 shall have the meaning given in that schedule.

# Schedule 1- Site plan

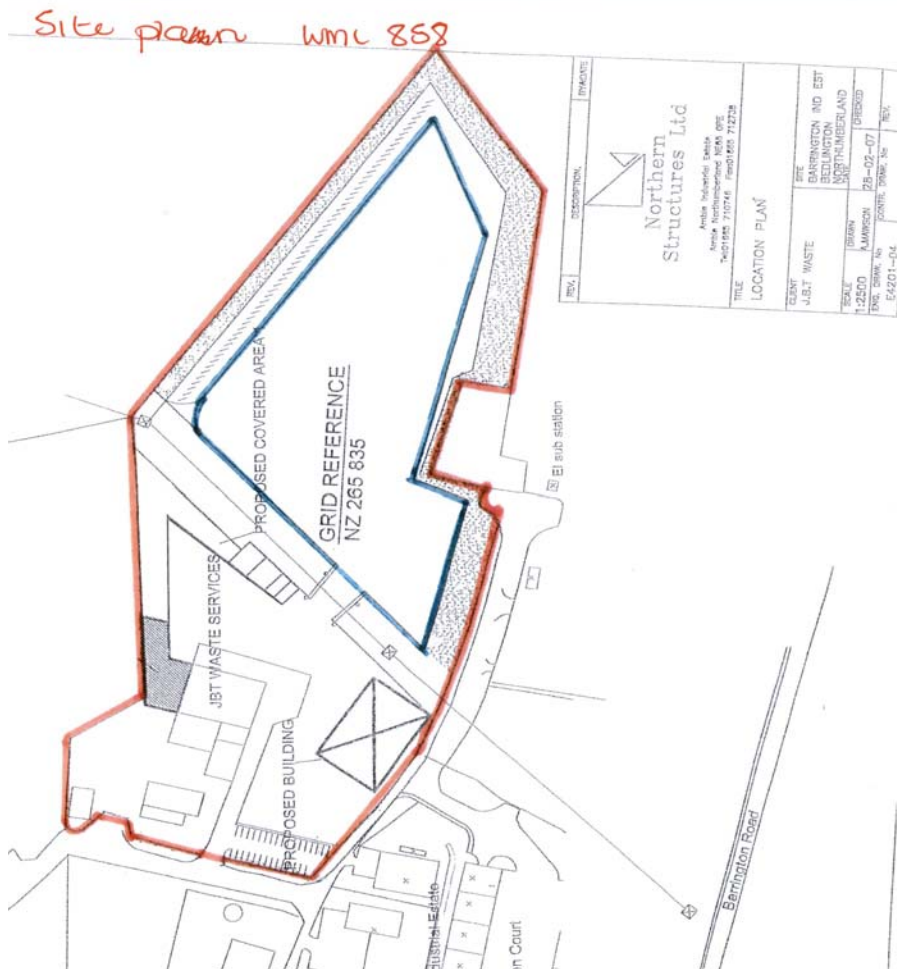



## Schedule 2 - Operations

Table 2.1 Licensed activities	
Description of activities	Limits of activities
<p><b>D15:</b> Storage of waste pending any of the operations listed in paragraphs 1 to 14 of this Part of this Schedule, but excluding temporary storage, pending collection, on the site where the waste is produced.</p> <p><b>R13:</b> Storage of waste pending any of the operations listed in paragraphs 1 to 12 of this Part of this Schedule, but excluding temporary storage, pending collection, on the site where it is produced.</p> <p><b>D14:</b> Repackaging of waste prior to the waste being submitted to any of the operations listed in paragraphs 1 to 13 of this Part of this Schedule.</p>	<p>All bulking or transfer of non-hazardous waste must be carried out inside a building.</p> <p>Non-hazardous wastes must be kept in a building or within a secure container. Non-hazardous waste must be kept on an impermeable surface with sealed drainage.</p> <p>Inert wastes must be kept on hard standing or on an impermeable surface with sealed drainage.</p>
<p><b>D9:</b> Physico-chemical treatment of waste not listed elsewhere in this Part of this Schedule which results in final compounds or mixtures which are discarded by means of any of the operations listed in paragraphs 1 to 12 of this Part of this Schedule (for example, evaporation, drying, calcination).</p> <p><b>R3:</b> Recycling or reclamation of organic substances which are not used as solvents, including composting and other biological transformation processes.</p> <p><b>R4:</b> Recycling or reclamation of metals and metal compounds</p> <p><b>R5:</b> Recycling or reclamation of other inorganic materials</p>	<p>Treatment consisting only of manual sorting, separation, screening, baling, shredding, crushing or compaction of non-hazardous or inert waste into different components for disposal, (no more than 50 tonnes per day) or recovery.</p> <p>Treatment of non- hazardous waste must be carried out within a building.</p> <p>Non-hazardous waste must be treated on an impermeable surface with sealed drainage.</p> <p>Inert wastes must be treated on hard standing or on an impermeable surface with sealed drainage.</p>

Table 2.1 Licensed activities	
Description of activities	Limits of activities
<p><b>R13: Storage of waste consisting of materials intended for submission, on this site to any of the category "R" operations authorised under this column, or elsewhere than on this site, to any of the operations listed in Part IV of Schedule 4 of the 1994 Regulations, (excluding temporary storage, pending collection, on the site where it is produced).</b></p> <p><b>R3: Recycling or reclamation of organic substances which are not used as solvents, including composting and other biological transformation processes.</b></p> <p><b>R4: Recycling or reclamation of metals and metal compounds.</b></p> <p><b>R5: Recycling or reclamation of other inorganic materials.</b></p>	<p>Storage</p> <ul style="list-style-type: none"> <li>• WEEE, disassembled spare parts, components or residues must be stored on an impermeable surface with sealed drainage with provision of spillage collection facilities and, where appropriate, decanters and cleanser degreasers;</li> <li>• WEEE, disassembled spare parts, components or residues must be stored in areas provided with a weatherproof covering where appropriate or in containers providing a weatherproof covering where appropriate;</li> <li>• disassembled spare parts containing liquids shall be stored in appropriate containers;</li> <li>• Batteries, PCBs/PCTs containing capacitors and other hazardous wastes must be stored in dedicated, labelled appropriate containers.</li> </ul> <p>Storage of WEEE containing ozone-depleting substances</p> <ul style="list-style-type: none"> <li>• Storage shall be undertaken on impermeable pavement with a sealed drainage system.</li> <li>• Shall be kept separate.</li> <li>• Free storage shall not exceed a maximum of 3.5 metres or 5 fridge units laid on their side with the door in place for structural integrity.</li> <li>• Palletised or racked storage shall not exceed a height of 5 metres unless otherwise agreed in writing.</li> </ul> <p>Buildings, covered areas or containers must meet the following requirements:</p> <ul style="list-style-type: none"> <li>• buildings, covered areas, or containers must be designed, constructed and maintained to prevent ingress of rain and surface water;</li> <li>• rain and uncontaminated surface water must be kept separate from contaminated water and other liquids;</li> <li>• containers must be stored on an impermeable surface with sealed drainage.</li> </ul> <p>The capacity of the site for hazardous waste subject to a R5 activity shall not exceed 10 tonnes per day.</p> <p>Maximum storage time of 1 year prior to disposal or 3 years prior to recovery. Dated: 29/09/08</p>
<p>Licence No. EAWML 100321</p>	<p>Page 10</p>

<b>Table 2.2 Licensed waste types and quantities</b>	
<b>Maximum Quantities</b>	
The quantity of wastes listed below, accepted at the site shall be more than 75,000 tonnes a year.	
<b>Exclusions</b>	
Notwithstanding the specification of waste types below, wastes shall not be accepted at the site which have any of the following characteristics:	
<ul style="list-style-type: none"> <li>• Consisting solely or mainly of dusts, powders or loose fibres</li> </ul>	

<b>01 WASTES RESULTING FROM EXPLORATION, MINING, QUARRYING, AND PHYSICAL AND CHEMICAL TREATMENT OF MINERALS</b>	
01 01	wastes from mineral excavation
01 01 01	wastes from mineral metalliferous excavation
01 01 02	wastes from mineral non-metalliferous excavation
01 03	wastes from physical and chemical processing of metalliferous minerals
01 03 05	Other tailings containing dangerous substances
01 03 09	Red mud from alumina production other than wastes mentioned in 01 03 07
01 04	wastes from physical and chemical processing of non-metalliferous minerals
01 04 08	waste gravel and crushed rocks other than those mentioned in 01 04 07
01 04 09	waste sand and clays
01 04 10	Dusty and powdery wastes other than those mentioned in 01 04 07
01 04 11	wastes from potash and rock salt processing other than those mentioned in 01 04 07
01 04 12	tailings and other wastes from washing and cleaning of minerals other than those mentioned in 01 04 07 and 01 04.11
01 04 13	wastes from stone cutting and sawing other than those mentioned in 01 04 07
01 05	drilling muds and other drilling wastes
01 05 04	freshwater drilling muds and wastes
<b>02 WASTES FROM AGRICULTURE, HORTICULTURE, AQUACULTURE, FORESTRY, HUNTING AND</b>	

<b>FISHING, FOOD PREPARATION AND PROCESSING</b>	
02 01	wastes from agriculture, horticulture, aquaculture, forestry, hunting and fishing
02 01 01	sludges from washing and cleaning
02 01 03	plant-tissue waste
02 01 04	waste plastics (except packaging)
02 01 06	animal faeces, urine and manure (including spoiled straw), effluent, collected separately and treated off site
02 01 07	wastes from forestry
02 01 09	agrochemical waste other than those mentioned in 02 01 08
02 01 10	waste metal
02 02	wastes from the preparation and processing of meat, fish and other foods of animal origin
02 02 01	sludges from washing and cleaning
02 02 03	materials unsuitable for consumption or processing
02 02 04	sludges from on-site effluent treatment
02 03	wastes from fruit, vegetables, cereals, edible oils, cocoa, coffee, tea and tobacco preparation and processing; conserve production; yeast and yeast extract production, molasses preparation and fermentation
02 03 01	sludges from washing, cleaning, peeling, centrifuging and separation
02 03 02	wastes from preserving agents
02 03 03	wastes from solvent extraction
02 03 05	sludges from on-site effluent treatment
02 04	wastes from sugar processing
02 04 01	soil from cleaning and washing beet
02 04 02	off-specification calcium carbonate
02 04 03	sludges from on-site effluent treatment
02 05	wastes from the dairy products industry
02 05 01	materials unsuitable for consumption or processing
02 05 02	sludges from on-site effluent treatment
02 06	wastes from the baking and confectionery industry
02 06 01	materials unsuitable for consumption or processing
02 06 02	wastes from preserving agents
02 06 03	sludges from on-site effluent treatment
02 07	wastes from the production of alcoholic and non-alcoholic beverages (except coffee, tea and cocoa)
02 07 01	wastes from washing, cleaning and mechanical reduction of raw materials
02 07 02	wastes from spirits distillation
02 07 03	wastes from chemical treatment
02 07 04	materials unsuitable for consumption or processing
02 07 05	sludges from on-site effluent treatment

<b>03</b>	<b>WASTES FROM WOOD PROCESSING AND THE PRODUCTION OF PANELS AND FURNITURE, PULP, PAPER AND CARDBOARD</b>
03 01	wastes from wood processing and the production of panels and furniture
03 01 01	waste bark and cork
03 01 04	sawdust, shavings, cuttings, wood, particle board and veneer containing dangerous substances
03 01 05	sawdust, shavings, cuttings, wood, particle board and veneer other than those mentioned in 03 01 04
03 03	wastes from pulp, paper and cardboard production and processing
03 03 01	waste bark and wood
03 03 05	de-inking sludges from paper recycling
03 03 07	mechanically separated rejects from pulping of waste paper and cardboard
03 03 08	wastes from sorting of paper and cardboard destined for recycling
03 03 10	Fibre rejects, fibre-, filler- and coating-sludges from mechanical separation
03 03 11	sludges from on-site effluent treatment other than those mentioned in 03 03 10
<b>04</b>	<b>WASTES FROM THE LEATHER, FUR AND TEXTILE INDUSTRIES</b>
04 02	wastes from the textile industry
04 02 09	wastes from composite materials (impregnated textile, elastomer, plastomer)
04 02 10	organic matter from natural products (for example grease, wax)
04 02 21	wastes from unprocessed textile fibres
04 02.22	wastes from processed textile fibres
<b>05</b>	<b>Wastes from Petroleum Refining, Natural Gas Purification and Pyrolytic Treatment of Coal</b>
05 01	wastes from petroleum refining
05 01 17	bitumen
<b>06</b>	<b>WASTES FROM INORGANIC CHEMICAL PROCESSES</b>
06 09	wastes from the MFSU of phosphorous chemicals and phosphorous chemical processes
06 09 02	phosphorous slag
06 13	wastes from inorganic chemical processes not otherwise specified
06 13 03	carbon black
<b>07</b>	<b>WASTES FROM ORGANIC CHEMICAL PROCESSES</b>
07 02	wastes from the MFSU of plastics, synthetic rubber and man-made fibres
07 02 13	waste plastic
07 02 15	wastes from additives other than those mentioned in 07 02 14
07 02 17	wastes containing silicones other than those mentioned in 07 02 16
<b>08</b>	<b>Wastes from Manufacture, Formulation, Supply and Use (MFSU) of Coatings (Paints, Varnishes and Vitreous Enamels), Adhesives, Sealants and Printing Inks</b>
08 02	wastes from MFSU or other coatings (including ceramic materials)
08 02 01	waste coating powders
08 03	wastes from MFSU of printing inks
08 03 18	waste printing toner other than those mentioned in 08 03 17

08 04	wasted from MFSU od adhesives and sealants (including waterproofing products)
08 04 10	waste adhesives and sealants other than those mentioned in 08 04 09
08 04 12	adhesive and sealant sludges containing adhesives or sealants other than those mentioned in 08 04 11
08 04 14	aqueous sludges containing adhesives or sealants other than those mentioned in 08 04 13
<b>09</b>	<b>WASTES FROM THE PHOTOGRAPHIC INDUSTRY</b>
09 01	wastes from the photographic industry
09 01 07	photographic film and paper containing silver or silver compounds
09 01 08	photographic film and paper free of silver or silver compounds
09 01 10	single-use cameras without batteries
09 01 12	single-use cameras containing batteries other than those mentioned in 09 01.11
<b>10</b>	<b>WASTES FROM THERMAL PROCESSES</b>
10 01	wastes from power stations and other combustion plants (except 19)
10 01 01	bottom ash, slag and boiler dust (excluding boiler dust mentioned in 10 01 04)
10 01 02	coal fly ash
10 01 03	fly ash from peat and untreated wood
10 01 15	bottom ash, slag and boiler dust from co-incineration other than those mentioned in 10 01 14
10 01 16	fly ash from co-incineration containing dangerous substances
10 01 17	fly ash from co-incineration other than those mentioned in 10 0116
10 01 24	sands from fluidised beds
10 02	wastes from the iron and steel industry
10 02 01	wastes from the processing of slag
10 02 02	unprocessed slag
10 02 08	solid wastes from gas treatment other than those mentioned in 10 02 07
10 02 10	mill scales
10 02 14	filter cakes from gas treatment other than those mentioned in 10 02.13
10 02 15	other filter cakes
10 03	wastes from aluminium thermal metallurgy
10 03 02	anode scraps
10 03 05	waste alumina
10 03 16	skimmings other than those mentioned in 10 03 15
10 03 18	carbon-containing wastes from anode manufacture other than those mentioned in 10 03 17
10 03 24	solid wastes from gas treatment other than those mentioned in 10 03.23
10 03 26	filter cakes from gas treatment other than those mentioned in 10 03.25
10 03 28	wastes from cooling-water treatment other than those mentioned in 10 03.27
10 08	wastes from other non-ferrous thermal metallurgy
10 08 09	other slags

10 08 13	carbon-containing wastes from anode manufacture other than those mentioned in 10 08.12
10 08 14	anode scrap
10 08 18	filter cakes from flue-gas treatment other than those mentioned in 10 08 17
10 09	wastes from casting of ferrous pieces
10 09 03	furnace slag
10 09 06	casting cores and moulds which have not undergone pouring other than those mentioned in 10 09 05
10 09 08	casting cores and moulds which have undergone pouring other than those mentioned in 10 09 07
10 09 12	other particulates other than those mentioned in 10 09 11
10 09 14	waste binders other than those mentioned in 10 09.13
10 10	wastes from casting of non-ferrous pieces
10 10 03	furnace slag
10 10 06	casting cores and moulds which have not undergone pouring, other than those mentioned in 10 10 05
10 10 08	casting cores and moulds which have undergone pouring, other than those mentioned in 10 10 07
10 10 12	other particulates other than those mentioned in 10 10 11
10 10 14	waste binders other than those mentioned in 10 10.13
10 10 16	waste crack-indicating agent other than those mentioned in 10 10 15
10 11	wastes from manufacture of glass and glass products
10 11 03	waste glass-based fibrous materials
10 11 05	particulates and dust
10 11 12	waste glass other than those mentioned in 10.11.11
10 11 18	filter cakes from flue-gas treatment other than those mentioned in 10.11 17
10 11 20	solid wastes from on-site effluent treatment other than those mentioned in 10 11 19
10 12	wastes from manufacture of ceramic goods, bricks, tiles and construction products
10 12 01	waste preparation mixture before thermal processing
10 12 03	particulates and dust
10 12 05	filter cakes from gas treatment
10 12 06	discarded moulds
10 12 08	waste ceramics, bricks, tiles and construction products (after thermal processing)
10 12 10	solid wastes from gas treatment other than those mentioned in 10.12 09
10 12 12	wastes from glazing other than those mentioned in 10.12.11
10 12 13	sludge from on-site effluent treatment
10 13	wastes from manufacture of cement, lime and plaster and articles and products made from them
10 13 01	waste preparation mixture before thermal processing
10 13 04	wastes from calcination and hydration of lime

10 13 07	filter cakes from gas treatment
10 13 11	wastes from cement-based composite materials other than those mentioned in 10.13 09 and 10.13 10
10 13 13	solid wastes from gas treatment other than those mentioned in 10.13.12
10 13 14	waste concrete
<b>11</b>	<b>WASTES FROM CHEMICAL SURFACE TREATMENT AND COATING OF METALS AND OTHER MATERIALS; NON-FERROUS HYDRO METALLURGY</b>
11 02	wastes from non-ferrous hydrometallurgical processes
11 02 03	wastes from the production of anodes for aqueous electrolytical processes
<b>12</b>	<b>WASTES FROM SHAPING AND PHYSICAL AND MECHANICAL SURFACE TREATMENT OF METALS AND PLASTICS</b>
12 01	wastes from shaping and physical and mechanical surface treatment of metals and plastics
12 01 01	ferrous metal filings and turnings
12 01 02	ferrous metal dust and particles
12 01 03	non-ferrous metal filings and turnings
12 01 04	non-ferrous metal dust and particles
12 01 05	plastics shavings and turnings
12 01 13	welding wastes
12 01 15	machining sludges other than those mentioned in 12 01 14
12 01 17	waste blasting material other than those mentioned in.12 01 16
12 01 21	spent grinding bodies and grinding materials other than those mentioned in.12 01.20
<b>15</b>	<b>WASTE PACKAGING; ABSORBENTS, WIPING CLOTHS, FILTER MATERIALS AND PROTECTIVE CLOTHING NOT OTHERWISE SPECIFIED</b>
15 01	packaging (including separately collected municipal packaging waste)
15 01 01	paper and cardboard packaging
15 01 02	plastic packaging
15 01 03	wooden packaging
15 01 04	metallic packaging
15 01 05	composite packaging
15 01 06	mixed packaging
15 01 07	glass packaging
15 01 09	textile packaging
15 02	absorbents, filter materials, wiping cloths and protective clothing
15 02 03	absorbents, filter materials, wiping cloths and protective clothing other than those mentioned in 15 02 02
<b>16</b>	<b>WASTES NOT OTHERWISE SPECIFIED IN THE LIST</b>
16 01	end-of-life vehicles from different means of transport [including off-road machinery] and wastes from dismantling of end-of-life vehicles and vehicle maintenance (except 13,14 16 06 and 16 08)
16 01 03	end-of-life tyres



16 01 04	end-of-life vehicles
16 01 06	end-of-life vehicles containing neither liquids nor other hazardous components
16 01 12	brake pads other than those mentioned in 16 01 11
16 01 17	ferrous metal
16 01 18	non-ferrous metal
16 01 19	plastic
16 01 20	glass
16 01 22	components not otherwise specified
16 02	wastes from electrical and electronic equipment
16 02 09	transformers and capacitors containing PCBs
16 02 10	discarded equipment containing or contaminated by PCBs other than those mentioned in 16 02 09
16 02 11	discarded equipment containing chlorofluorocarbons, HCFC, HFC
16 02 12	discarded equipment containing free asbestos
16 02 13	discarded equipment containing hazardous components other than those mentioned in 16 02 09 to 16 02 12
16 02 14	discarded equipment other than those mentioned in 16 02 09 to 16 02.13
16 02 16	components removed from discarded equipment other than those mentioned in 16 02 15
16 03	off-specification batches and unused products
16 03 04	inorganic wastes other than those mentioned in 16 03 03
16 03 06	organic wastes other than those mentioned in 16 03 05
16 05	gases in pressure containers and discarded chemicals
16 05 05	gases in pressure containers other than those mentioned in 16 05 04
16 05 09	discarded chemicals other than those mentioned in 16 05 06, 16 05 07 or 16 05 08
16 06	batteries and accumulators
16 06 01	lead batteries
16 06 02	Ni-Cd batteries
16 06 03	mercury containing batteries
16 06 04	alkaline batteries (except 16 06 03)
16 06 05	other batteries and accumulators
16 08	spent catalysts
16 08 03	spent catalysts containing transition metals or transition metal compounds not otherwise specified
16 11	waste linings and refractories
16 11 02	carbon-based linings and refractories from metallurgical processes others than those mentioned in 16.11 01
16 11 04	other linings and refractories from metallurgical processes other than those mentioned in 16.11 03
16 11 06	linings and refractories from non-metallurgical processes others than those mentioned in 16.11 05

<b>17 CONSTRUCTION AND DEMOLITION WASTES (INCLUDING EXCAVATED SOIL FROM CONTAMINATED SITES)</b>	
17 01	concrete, bricks, tiles and ceramics
17 01 01	concrete
17 01 02	bricks
17 01 03	tiles and ceramics
17 01 06	mixtures of, or separate fractions of concrete, bricks, tiles and ceramics containing dangerous substances
17 01 07	mixtures of concrete, bricks, tiles and ceramics other than those mentioned in 17 01 06
17 02	wood, glass and plastic
17 02 01	wood
17 02 02	glass
17 02 03	plastic
17 02 04	glass plastic and wood containing or contaminated with dangerous substances
17 03	bituminous mixtures, coal tar and tarred products
17 03 01	bituminous mixtures containing coal tar
17 03 02	bituminous mixtures other than those mentioned in 17 03 01
17 04	metals (including their alloys)
17 04 01	copper, bronze, brass
17 04 02	aluminium
17 04 03	lead
17 04 04	zinc
17 04 05	iron and steel
17 04 06	tin
17 04 07	mixed metals
17 04 11	cables other than those mentioned in 17 04 10
17 05	soil (including excavated soil from contaminated sites), stones and dredging spoil
17 05 03	soil and stones containing dangerous substances
17 05 04	soil and stones other than those mentioned in 17 05 03
17 05 06	dredging spoil other than those mentioned in 17 05 05
17 05 08	track ballast other than those mentioned in 17 05 07
17 06	insulation materials and asbestos-containing construction materials
17 06 04	insulation materials other than those mentioned in 17 06 01 and 17 06 03
17 08	gypsum-based construction material
17 08 02	gypsum-based construction materials other than those mentioned in 17 08 01
17 09	other construction and demolition wastes
17 09 04	mixed construction and demolition wastes other than those mentioned in 17 09 01, 17 09 02 and 17 09 03
<b>19 WASTES FROM WASTE MANAGEMENT FACILITIES, OFF-SITE WASTE WATER TREATMENT PLANTS AND PREPARATION OF WATER INTENDED FOR HUMAN CONSUMPTION/INDUSTRIAL</b>	

USE	
19 01	wastes from incineration or pyrolysis of waste
19 01 02	ferrous materials removed from bottom ash
19 01 12	bottom ash and slag other than those mentioned in 19 01.11
19 01 14	fly ash other than those mentioned in 19 01 13
19 01 16	boiler dust other than those mentioned in 19 01 15
19 01 18	pyrolysis wastes other than those mentioned in 19 01 17
19 01 19	sands from fluidised beds
19 02	wastes from physico/chemical treatments of waste (including dechromatation, decyanidation, neutralisation)
19 02 03	premixed wastes composed only of non-hazardous wastes
19 03	stabilised/solidified waste
19 03 05	stabilised wastes other than those mentioned in 19 03 04
19 03 07	solidified wastes other than those mentioned in 19 03 06
19 04	vitrified waste and wastes from vitrification
19 04 01	vitrified waste
19 05	wastes from aerobic treatment of solid wastes
19 05 01	non-composted fraction of municipal and similar wastes
19 05 02	non-composted fraction of animal and vegetable waste
19 05 03	off-specification compost
19 06	wastes from anaerobic treatments of waste
19 06 04	digestate from anaerobic treatment of municipal waste
19 06 06	digestate from anaerobic treatment of animal and vegetable waste
19 07	landfill leachate
19 07 03	landfill leachate other than those mentioned in 19 07 02
19 08	wastes from waste water treatment plants not otherwise specified
19 08 02	waste from desanding
19 08 05	sludges from treatment of urban waste water
19 09	wastes from the preparation of water intended for human consumption or water for industrial use
19 09 01	solid waste from primary filtration and screenings
19 09 02	sludges from water clarification
19 09 03	sludges from decarbonation
19 09 04	spent activated carbon
19 10	wastes from shredding of metal containing wastes
19 10 01	iron and steel waste
19 10 02	non-ferrous waste
19 10 04	fluff light fraction and dust other than those mentioned in 19 10 03
19 10 06	other fractions other than those mentioned in 19 10 05

19 11	wastes from oil regeneration
19 11 06	sludges from on-site effluent treatment other than those mentioned in 19 11 05
19.12	wastes from the mechanical treatment of waste (for example sorting, crushing, compacting, pelletising) not otherwise specified
19 12 01	paper and cardboard
19 12 02	ferrous metal
19 12 03	non-ferrous metal
19 12 04	plastic and rubber
19 12 05	glass
19 12 06	wood containing dangerous substances
19 12 07	wood other than that mentioned in 19.12 06
19 12 08	textiles
19 12 09	minerals (for example sand, stones)
19 12 10	combustible waste (refuse derived fuel)
19 12 12	other wastes (including mixtures of materials) from mechanical treatment of wastes other than those mentioned in 19 12 11
19 13	wastes from soil and groundwater remediation
19 13 02	solid wastes from soil remediation other than those mentioned in 19 13 01
19 13 04	sludges from soil remediation other than those mentioned in 19 13 03
<b>20</b>	<b>MUNICIPAL WASTES (HOUSEHOLD WASTE AND SIMILAR COMMERCIAL, INDUSTRIAL AND INSTITUTIONAL WASTES) INCLUDING SEPARATELY COLLECTED FRACTIONS</b>
20 01	separately collected fractions (except 15 01)
20 01 01	paper and cardboard
20 01 02	glass
20 01 08	biodegradable kitchen and canteen waste
20 01 10	clothes
20 01 11	textiles
20 01 21	fluorescent tubes and other mercury containing waste
20 01 22	discarded equipment containing chlorofluorocarbons
20 01 28	paint, inks, adhesives, and resins other than those mentioned in 20 01 27
20 01 30	detergents other than those mentioned in 20 01 29
20 01 33	batteries and accumulators including 16 06 01, 16 06 02 or 16 06 03 and unsorted batteries and accumulators containing these batteries
20 01 34	batteries and accumulators other than those mentioned in.20 01.33
20 01 35	discarded electrical and electronic equipment other than those mentioned in 20 01 21 and 20 01 23 containing hazardous components
20 01 36	discarded electrical and electronic equipment other than those mentioned in.20 01.21,.20 01.23 and.20 01.35
20 01 37	wood containing dangerous substances
20 01 38	wood other than that mentioned in.20 01.37

---

20 01 39	plastics
20 01 40	metals
20 02	garden and park wastes (including cemetery waste)
20 02 01	biodegradable waste
20 02 02	soil and stones
20 02 03	other non-biodegradable wastes
20 03	other municipal wastes
20 03 01	mixed municipal waste
20 03 02	waste from markets
20 03 03	street-cleaning residues
20 03 07	bulky waste

---

## Schedule 3 – Interpretation

*“accident”* means an accident that may result in pollution.

*“authorised officer”* means any person authorised by the Agency under section 108(1) of The Environment Act 1995 to exercise, in accordance with the terms of any such authorisation, any power specified in Section 108(4) of that Act.

*“best available treatment, recovery and recycling techniques”* shall have the meaning given to it by regulation 1(3) of the Waste Management Licensing Regulations 1994 as amended by The Waste Electrical and Electronic Equipment (Waste Management Licensing) (England and Wales) Regulations 2006

*“building”* means a construction that has the objective of providing sheltering cover and minimising emissions of noise, particulate matter, odour and litter

*“controlled substances”* means chlorofluorocarbons, other fully halogenated chlorofluorocarbons, halons, carbon tetrachloride, 1,1,1-trichloroethane, methyl bromide, hydrobromofluorocarbons and hydrochlorofluorocarbons listed in Annex I of Regulation (EC) No 2037/2000 of the European Parliament and of the Council of 29 June 2000 on substances that deplete the ozone layer, including their isomers, whether alone or in a mixture, and whether they are virgin, recovered, recycled or reclaimed. This definition shall not cover any controlled substance which is in a manufactured product other than a container used for the transportation or storage of that substance, or insignificant quantities of any controlled substance, originating from inadvertent or coincidental production during a manufacturing process, from unreacted feedstock, or from use as a processing agent which is present in chemical substances as trace impurities, or that is emitted during product manufacture or handling,

*“emissions to land”*, include emissions to groundwater.

*“fugitive emission”* means an emission to air, water or land from the activities which is not controlled by an emission limit.

*“groundwater”* means all water, which is below the surface of the ground in the saturation zone and in direct contact with the ground or subsoil.

*“impermeable surface”* means a surface or pavement constructed and maintained to a standard sufficient to prevent the transmission of liquids beyond the pavement surface, and should be read in conjunction with the term “sealed drainage system” (below).

*“notify/notified without delay”* means that a telephone call can be used, whereas all other reports and notifications must be supplied in writing, either electronically or on paper.

*“ozone-depleting substances”* “ODS” means “controlled substances” contained in refrigeration, air-conditioning and heat pump equipment, equipment containing solvents, fire protection systems and fire extinguishers.

*“pollution”* includes pollution of the environment, harm to human health and serious detriment to the amenities of the locality, resulting from the licensed activities.

*“quarter”* means a calendar year quarter commencing on 1 January, 1 April, 1 July or 1 October.

*“relevant person”* and *“relevant offence”* shall have the meaning given to them in the Environmental Protection Act 1990

*“sealed drainage system”* in relation to an impermeable surface, means a drainage system with impermeable components which does not leak and which will ensure that:

- (a) no liquid will run off the surface otherwise than via the system;
- (b) except where they may lawfully be discharged, all liquids entering the system are collected in a sealed sump.

*“sewer”* means sewer within the meaning of section 219(1) of the Water Industry Act 1991.

*“technically competent management”* and *“technical competence”* shall be as prescribed under Section 74 of the Environmental Protection Act 1990.

---

"*waste code*" means the code specified in The List of Wastes (England) Regulations 2005 (SI 2005 No. 895) as amended, or The List of Wastes (Wales) Regulations 2005 (SI 2005 No.1820) (W.148) as amended. Codes marked with an \* are hazardous waste, as defined in those regulations. Licence conditions apply to those wastes listed with a six-digit code.

"*Waste Management Licensing Regulations*", means The Waste Management Licensing Regulations 1994 (SI1994 No. 1056) (as amended).

"*weatherproof covering*" means covering which will prevent the ingress of rainwater.

"*WEEE*" means waste electrical and electronic equipment and has the meaning given by Regulation 2 of The Waste Electrical and Electronic Equipment Regulations 2006.

"*WEEE Directive*" shall have the meaning given to it by regulation 2 of The Waste Electrical and Electronic Equipment (Waste Management Licensing) (England and Wales) Regulations 2006.

"*where appropriate*" in relation to weatherproof covering means where weatherproof covering is required to minimise the contamination of clean surface and rain waters, to facilitate the reuse of whole appliances and components intended for reuse, to assist in the containment of hazardous materials and fluids or where hazardous WEEE is stored.

"*year*" means calendar year commencing on 1<sup>st</sup> January.

---

## **Schedule 4 – Substances, preparations and components to be removed from separately collected WEEE**

- Capacitors containing Polychlorinated biphenyls (PCB)
- Mercury-containing components, such as switches or backlighting lamps
- Batteries
- Printed circuit boards of mobile phones generally, and of other devices if the surface of the printed circuit board is greater than 10 square centimetres
- Toner cartridges, liquid and pasty, as well as colour toner
- Plastic containing brominated flame retardants
- Asbestos waste and components which contain asbestos
- Cathode ray tubes
- Chlorofluorocarbons (CFC), hydrochlorofluorocarbons (HCFC), hydrofluorocarbons (HFC), or hydrocarbons (HC)
- Gas discharge lamps
- Liquid crystal displays (together with their casing where appropriate) of a surface greater than 100 square centimetres and all those back-lighted with gas discharge lamps
- External electric cables
- Components containing refractory ceramic fibres
- Components containing radioactive substances with the exception of components that are below the exemption thresholds set in Article 3 of and the Annex I to Council Directive 96/29/Euratom of 13 May 1996 laying down basic safety standards for the protection of the health of workers and the general public against the dangers arising from ionising radiation
- Electrolytic capacitors containing “substances of concern” (height > 25mm, diameter > 25 mm or proportionately similar volume)